

COUNCIL
Dr. Monica Taylor
Chair
Elaine Paul Schaefer
Vice Chair



Department of Public Works
Danielle Floyd, Director

201 W. FRONT STREET
MEDIA, PA 19063

Kevin M. Madden
Christine A. Reuther
Richard R. Womack Jr.

COUNTY OF DELAWARE
GOVERNMENT CENTER BUILDING

PHONE (610) 891-4668
FAX (610) 891-4482

September 18, 2023

John McMullan
Township Manager
Middletown Township
27 N. Pennell Road
P.O. Box 157
Lima, PA 19037

Reference: Replacement of County Bridge #94 Manchester Road over Ridley Creek

Dear Mr. McMullan:

The County of Delaware is proceeding with the replacement of the above referenced bridge. The contract was awarded to Loftus Construction, Inc.

Please be informed that the contractor is planning to close a portion of Manchester Road and residents can expect to see detour signage beginning today. A barrier will be installed at the intersection of Manchester and Knowlton Roads. The barrier layout plan is attached for your reference.

The project is anticipated to be complete by March 5, 2025. The County will be holding regular construction meetings and will share important updates with you as the project progresses.

Should you have any additional question, please do not hesitate to contact our office at 610-891-4668.

Sincerely,

A handwritten signature in blue ink, appearing to read "Danielle J. Floyd".

Danielle J. Floyd

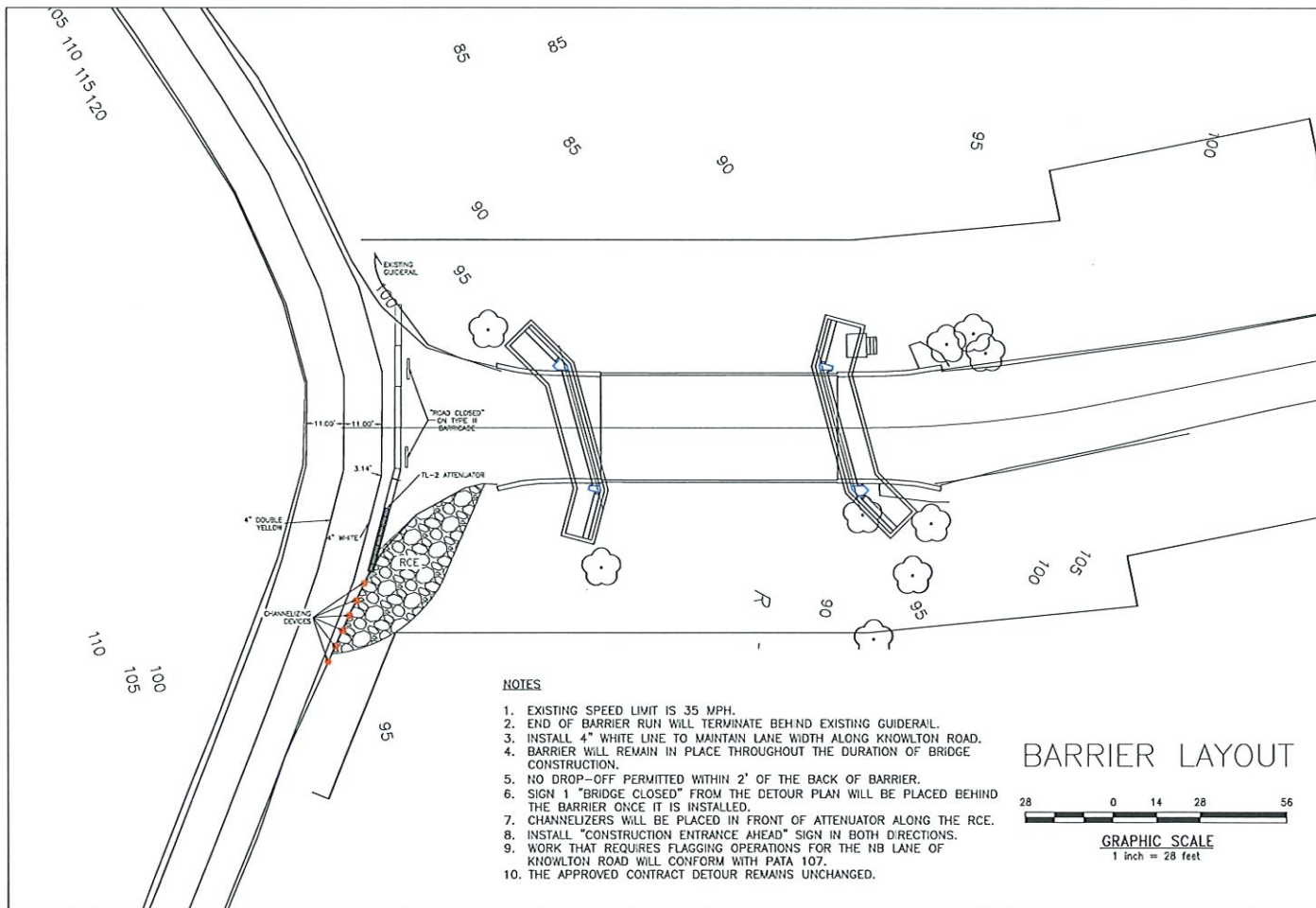

NOTES

1. EXISTING SPEED LIMIT IS 35 MPH.
2. END OF BARRIER RUN WILL TERMINATE BEHND EXISTING GUIDERAIL.
3. INSTALL 4" WHITE LINE TO MAINTAIN LANE WIDTH ALONG KNOWLTON ROAD.
4. BARRIER WILL REMAIN IN PLACE THROUGHOUT THE DURATION OF BRIDGE CONSTRUCTION.
5. NO DROP-OFF PERMITTED WITHIN 2' OF THE BACK OF BARRIER.
6. SIGN 1 "BRIDGE CLOSED" FROM THE DETOUR PLAN WILL BE PLACED BEHIND THE BARRIER ONCE IT IS INSTALLED.
7. CHANNELIZERS WILL BE PLACED IN FRONT OF ATTENUATOR ALONG THE RCE.
8. INSTALL "CONSTRUCTION ENTRANCE AHEAD" SIGN IN BOTH DIRECTIONS.
9. WORK THAT REQUIRES FLAGGING OPERATIONS FOR THE NB LANE OF KNOWLTON ROAD WILL CONFORM WITH PATA 107.
10. THE APPROVED CONTRACT DETOUR REMAINS UNCHANGED.

BARRIER LAYOUT

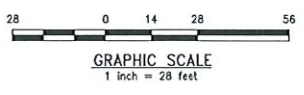

<p>LOFTUS CONSTRUCTION, INC. DESIGNERS - CONTRACTORS</p>	<p>MANCHESTER & KNOWLTON BARRIER DELOCO BRIDGE 94 - MANCHESTER ROAD DELAWARE COUNTY, PA.</p>
<p>DATE: 8/25/23</p>	<p>SCALE: N/A</p>
<p>JOB NO. 133212</p>	<p>Sheet: 1 OF 1</p>